

Light-Weight Class Over-Head Transfer Conveyor

ITZ-U2

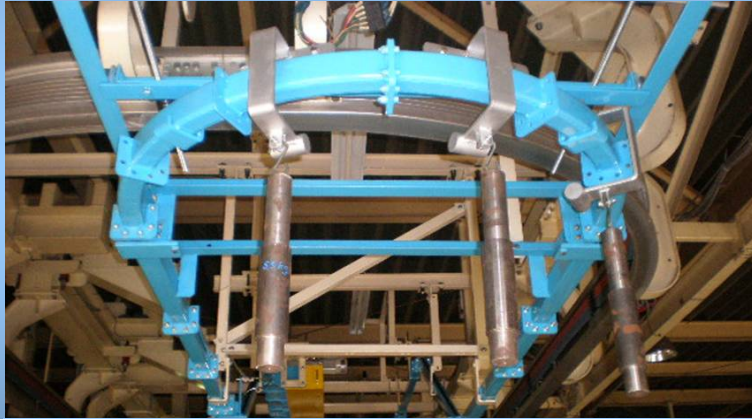

Izutech test line
You can see it anytime.



- Reduce a fall of garbage and the oil, for the rail ditch is to upward. ITZ type of minimum hanging pitch is 150mm, but this type is 200mm. And hanger dimension is smaller than ITZ-type to high direction. Possible to the space-saving.
- The chain which is using the universal block so. The load is reduced at the corner.
- Light-weight work transportation and various needs.
- Short delivered time.

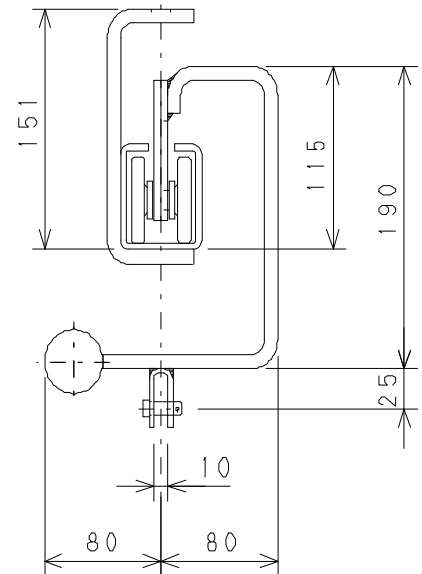
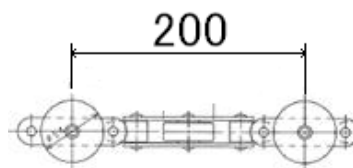

Main Specification

■ Work weight	Max.30kg (at pressed bearing using) Max.50kg (at plane retainer bearing using)		
■ Transfer speed	Max.12m/min.		
■ Vertical rail	Min.600mm turning radius		
■ Horizontal rail	Min.600mm turning radius		
■ Transfer pitch	Upper than 200mm (* x 200m)		
■ Max. slope angle	45° (by work weight limit)		
■ Heat resistance spec.	170°C		
■ Lubricator device	■ Index device	■ Turn device	■ Transfer device
etc. A variation-rich optional article			
■ Prepared the transfer device between Over-head and Floor transfer device.			