

Light-Weight Class Transfer Conveyor

FL 3-J1



POINTS

- Three-dimensional transportation is possible in small space.
- Possible to reciprocating transportation.
- Short delivered time.



Main Specification

- Work weight
- Transfer speed
- Vertical rail
- Horizontal rail
- Transfer pitch
- Max. slope angle

Max.30kg (15kg at up/down standard)
Max.15m/min.
Min.400mm turning radius
Min.400mm turning radius
Upper than 152.1mm
90° (by work weight limit)

■ Lubricator device

■ Turn device

■ Index device

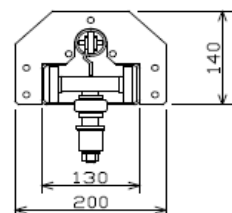

PAT商品